

# Assembly Instructions ■

Uniframe® Conver





**Tools Required:** 4mm Hex wrench,  $\frac{3}{8}$ " ratchet wrench,  $\frac{7}{16}$ " &  $\frac{9}{16}$ " sockets, adjustable wrench.

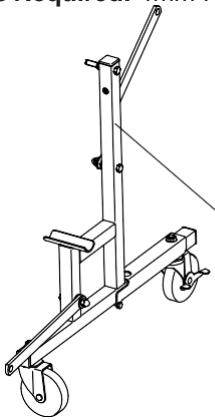

Support Leg Assembly  
Right-hand  
Qty. 1

Label on leg  
L=Left- & R=Right-hand  
Leg Assemblies

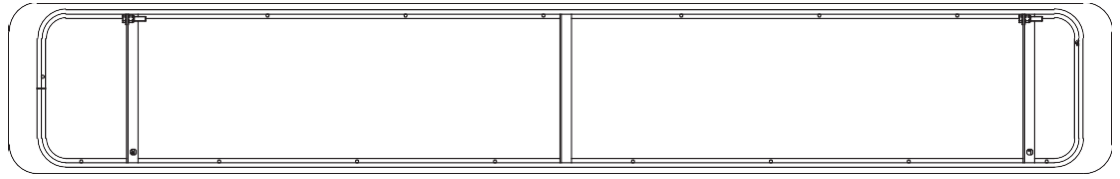

Top Assembly  
Qty. 1

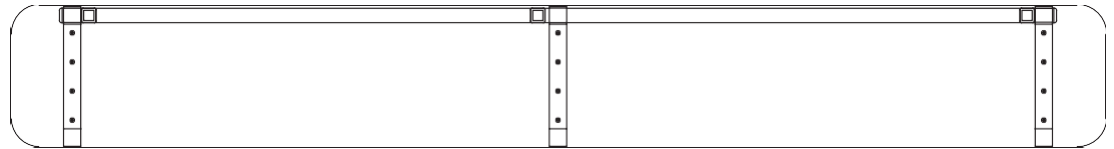

Bench Assembly  
Qty. 1

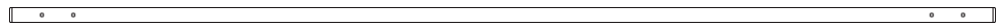

Main Horizontal Tube  
Qty. 1

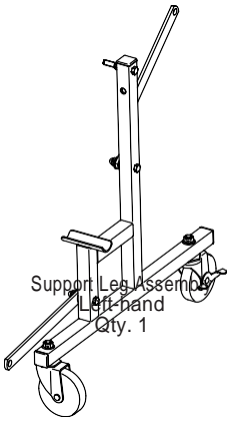

Support Leg Assembly  
Left-hand  
Qty. 1

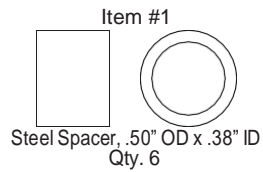

Item #1  
Steel Spacer, .50" OD x .38" ID  
Qty. 6

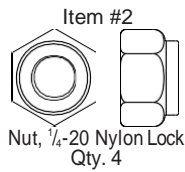

Item #2  
Nut,  $\frac{1}{4}$ "-20 Nylon Lock  
Qty. 4

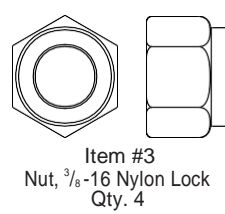

Item #3  
Nut,  $\frac{3}{8}$ "-16 Nylon Lock  
Qty. 4

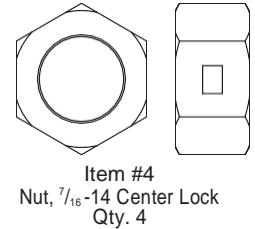

Item #4  
Nut,  $\frac{7}{16}$ "-14 Center Lock  
Qty. 4

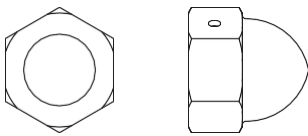

Item #5  
Nut,  $\frac{3}{8}$ "-16 UNC Acorn  
Qty. 2

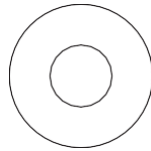

Item #6  
Flat Washer,  $\frac{1}{4}$ " SAE  
Qty. 4

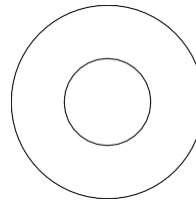

Item #7  
Flat Washer,  $\frac{3}{8}$ " SAE  
Qty. 12

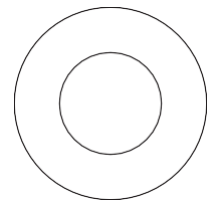

Item #8  
Flat Washer,  $\frac{1}{2}$ " Nylon  
Qty. 4

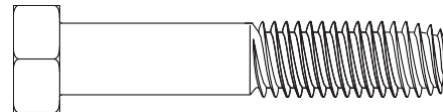
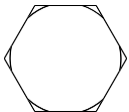

Item #9  
Hex Bolt,  $\frac{3}{4}$ "-16 x 2" HHCS  
Qty. 2

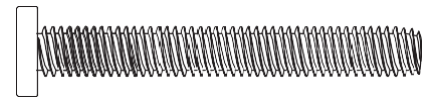

Item #10  
Socket Cap Screw,  $\frac{1}{4}$ "-20 Button Head  
Qty. 4

■ Uniframe® Convertible Bench  
Assembly Instructions

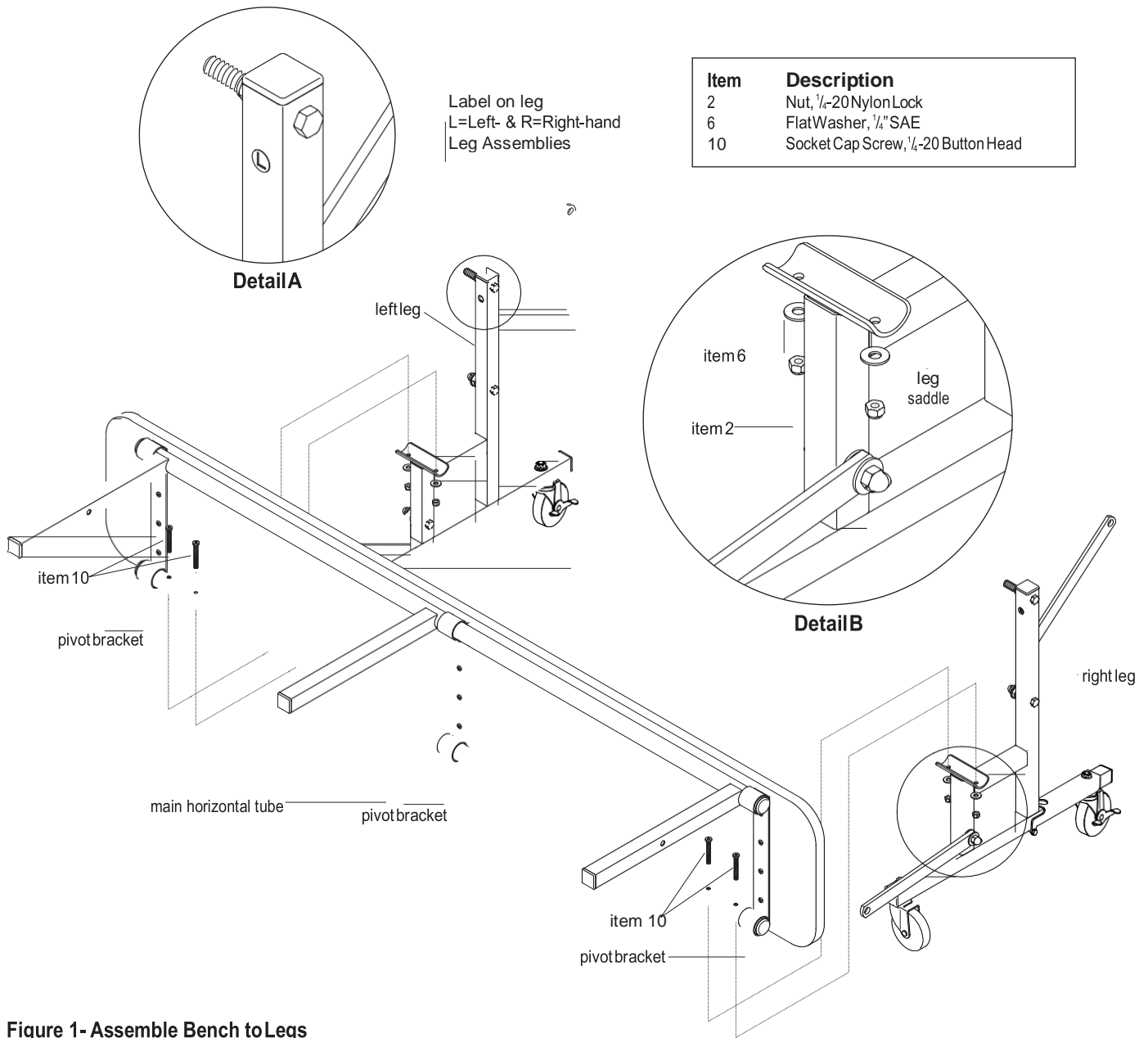

**Figure 1- Assemble Bench to Legs**

1. Identify right- & left-hand support leg assemblies by labels on upper support member (Figure 1 & Detail A).
2. Insert main horizontal tube through the pivot brackets in each bench assembly (Figure 1).
3. Insert four 1/4-20 x 2" screws (item 10) into main horizontal tube (Figure 1).
4. Place bench assembly with main tube onto leg saddles.
5. Align item 9 screws with holes and attach bench assembly with 1/4" flat washers (item 6) and 1/4-20 nylon lock nuts (item 2) (Figure 2 & Detail B).

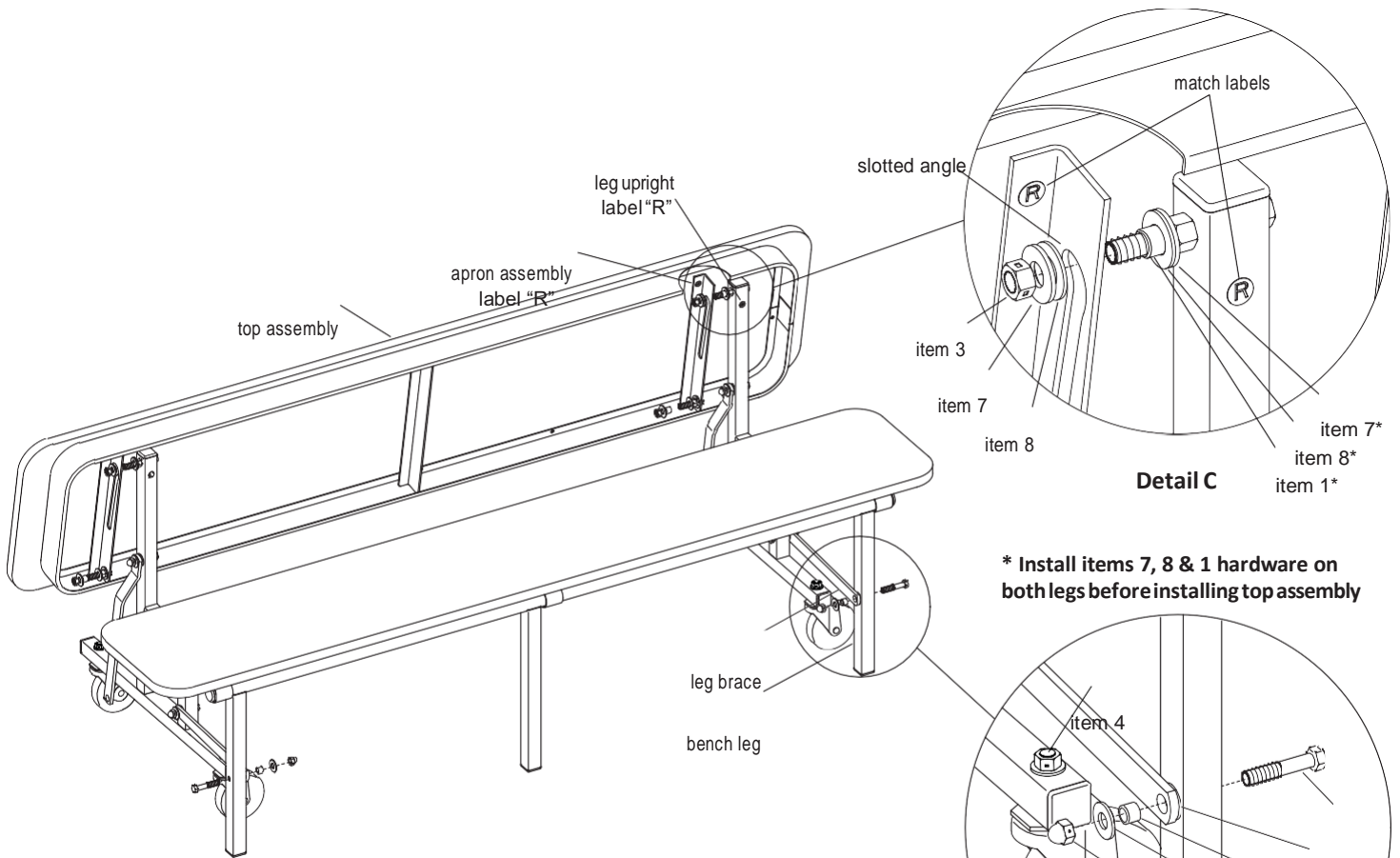

**Figure 2 - Braces to Top, Legs & Bench Assembly**

Item	Description
1	Steel Spacer, .50" OD x .38" ID
3	Nut, 7/8-16 Nylon Lock
4	Nut, 7/16-14 Center Lock
5	Nut, 7/8-16 UNC Acorn
7	Flat Washer, 3/8" SAE
8	Flat Washer, 1/2" Nylon
9	Hex Bolt, 7/8-16 x 2" HHCS

**\* Install items 7, 8 & 1 hardware on both legs before installing top assembly**

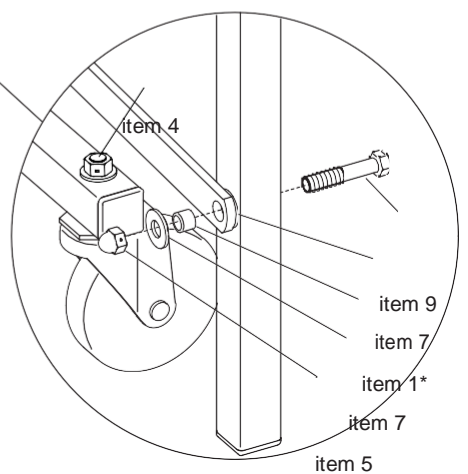

**Detail B**

**Bench Legs to Bench Brace**  
**\*Steel spacers allow the fasteners to tighten without restricting movement at pivot points**

1. Install leg braces to bench legs using hardware installed in sequence shown (Figure 2 & Detail B).
2. At top of leg uprights, install 3/8" flat washer (item 7), 1/2" nylon washer (item 8) and 3/8" steel spacer (item 1) onto leg bolts in sequence shown (Detail C).
3. Locate "L" and "R" labels on apron assembly under top.
4. Install top assembly through slotted angle over the spacers on bolts (Detail C).
5. Install 1/2" nylon washer (item 8), 3/8" flat washer (item 7) and 3/8-16 nylon lock nut (item 3) onto bolts and tighten (Detail C).

■ Uniframe® Convertible Bench  
Assembly Instructions

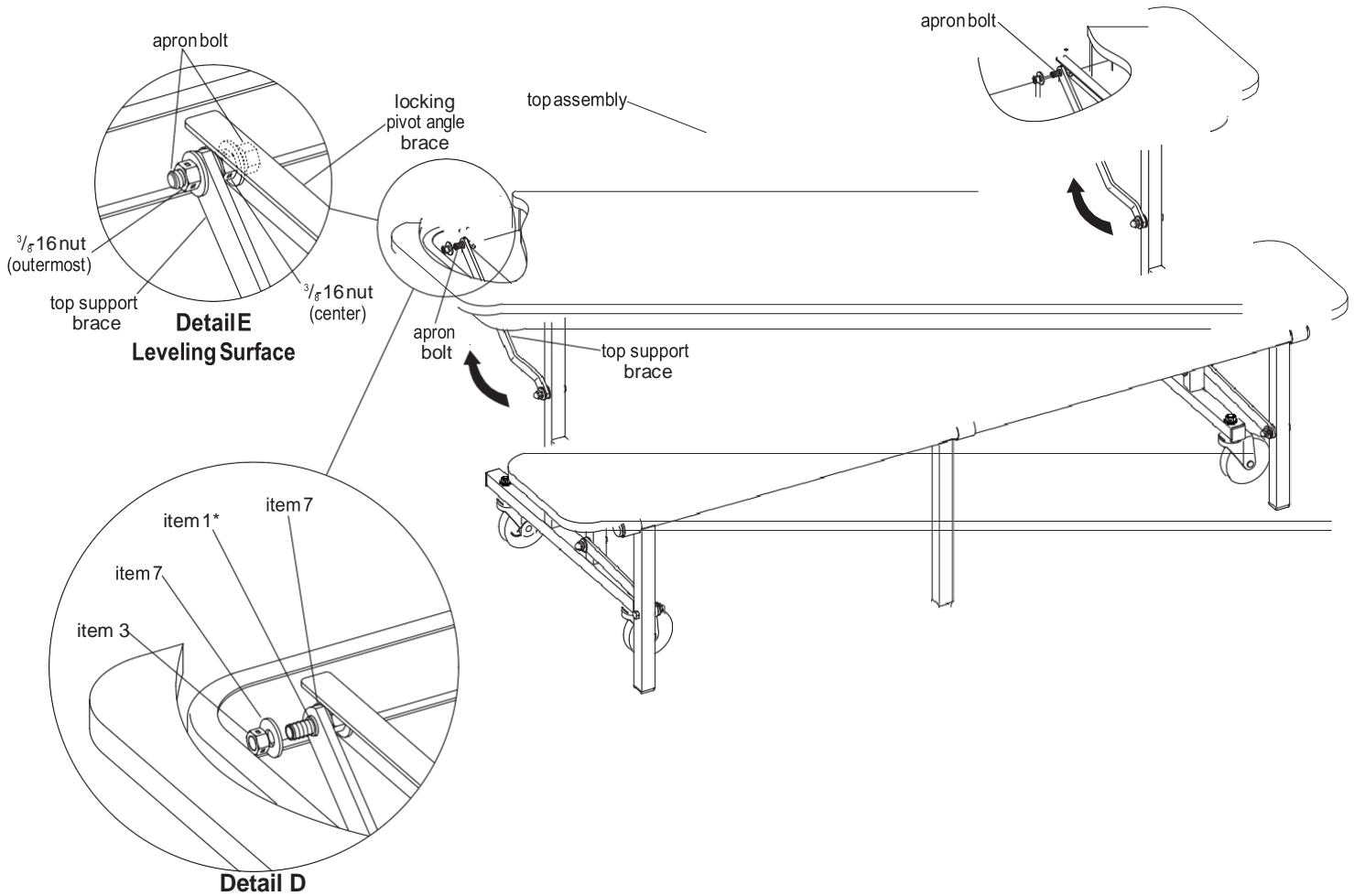

**Figure 3 - Braces to Top at Apron Assembly**

**Top Leg Brace to Apron**

\*Steel spacers allow the fasteners to tighten without restricting movement at pivot points

1. Attach  $\frac{3}{8}$ " flat washer (item 7) and steel spacer (item 1) onto both apron bolts in sequence shown (Figure 3 & Detail D).
2. Rotate top assembly up (Figure 3).
3. Rotate both top support brackets up and locate them onto the apron bolts. Spacers go into the brace hole (Figure 3 & Detail D).
4. Install  $\frac{3}{8}$ " flat washer (item 7) and  $\frac{3}{8}$ -16 nylon lock nut (item 3) onto apron bolts and tighten (Detail D).

movement at pivot points.

**Note:** Steel spacers allow the fasteners to tighten without restricting

**Note:** If the top surface assembly is not level once the top support brace is attached to the apron bolt, adjustments can be made at both ends of the top surface. The "apron bolt" is secured at the factory into a slotted hole in the "locking pivot angle brace" and this slot allows up to  $\frac{5}{8}$ " of adjustment.

5. To adjust the apron bolt on the locking pivot angle brace, first loosen the outermost top nut holding the top support brace to the apron bolt (if installed already in step 4). Next loosen the nut between the top support brace and the locking pivot angle brace by using two  $\frac{9}{16}$ " wrenches, one between the braces and one on the bolt head. Adjust the table to level, then re-tighten the nut and the bolt head which pinch the locking pivot angle brace only. Repeat procedure at other end of bench as necessary (Figure 3 & detail inset).





KI is a registered trademark  
of Krueger International, Inc.

©2016 Krueger International, Inc.  
All Rights Reserved  
Code KI-61586R10/KI/PDF/0616

Part # 13.7709

