

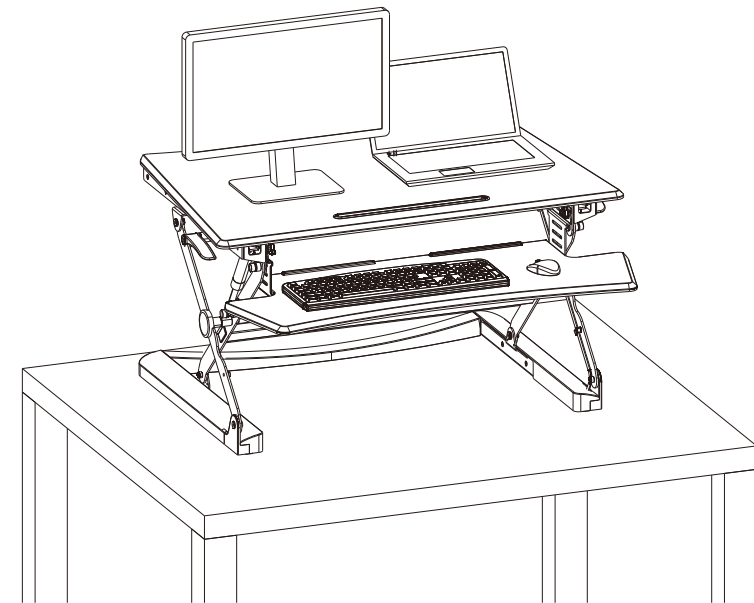

INSTALLATION GUIDE

Item No.: 5100-BLK



CAUTION

Please read all instructions carefully and thoroughly before using this product. Please keep this manual and all instructions for future reference. The specifications for this product may vary slightly from the illustrations and are subject to change without prior notice.

CAUTION

WARNING
Pinching Hazard
Strut moves during adjustment. Please do not place hands, wires or other objects on or near the strut during adjustment as it may cause pinching.



Please DO NOT put hands, wiring or other objects on or near the support bars, as they move while adjusting table, and may cause injury or damage.

CAUTION



Please ensure all equipment/accessories are firmly attached to the table, and do not hang over table edge as this may cause harm or damage.

CAUTION



Adhesive buckle is provided for cable management. Please ensure adequate cable length allows for the desired range of table adjustment/movement.

CAUTION

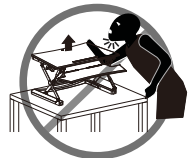

Please adjust table to full height position prior to removing the unit from tabletop or desk to avoid harm or damage.

CAUTION



Two people should be used to move this unit. Please do not attempt to move unit by yourself, as this may result in harm or damage.

Manufacturer: OFM Inc.
161 Tradition Trail
Holly Springs NC, 27540
800-520-7471
support@ofminc.com
www.ofminc.com

Technical Data

WARNING DO NOT exceed the maximum load-bearing capacity

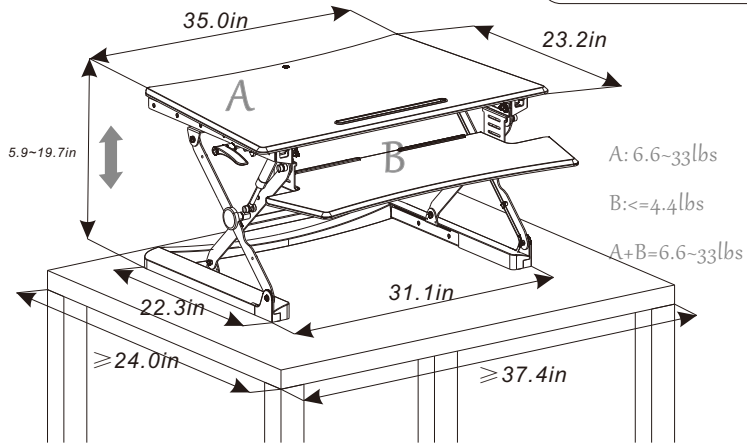
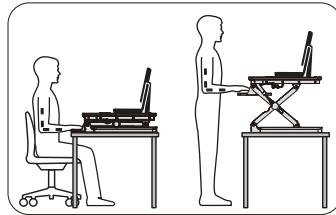

Accessory Package List

Note: The illustrations below are for reference only and may differ slightly from the actual part. If you have trouble with installation or are missing parts, please contact customer service immediately so we can remedy the problem quickly.

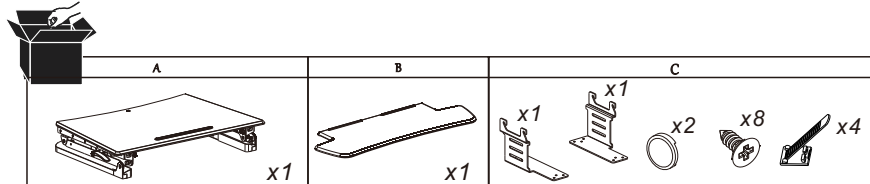

TOOLS

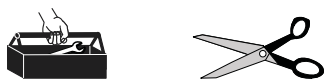

ASSEMBLY STEP 5

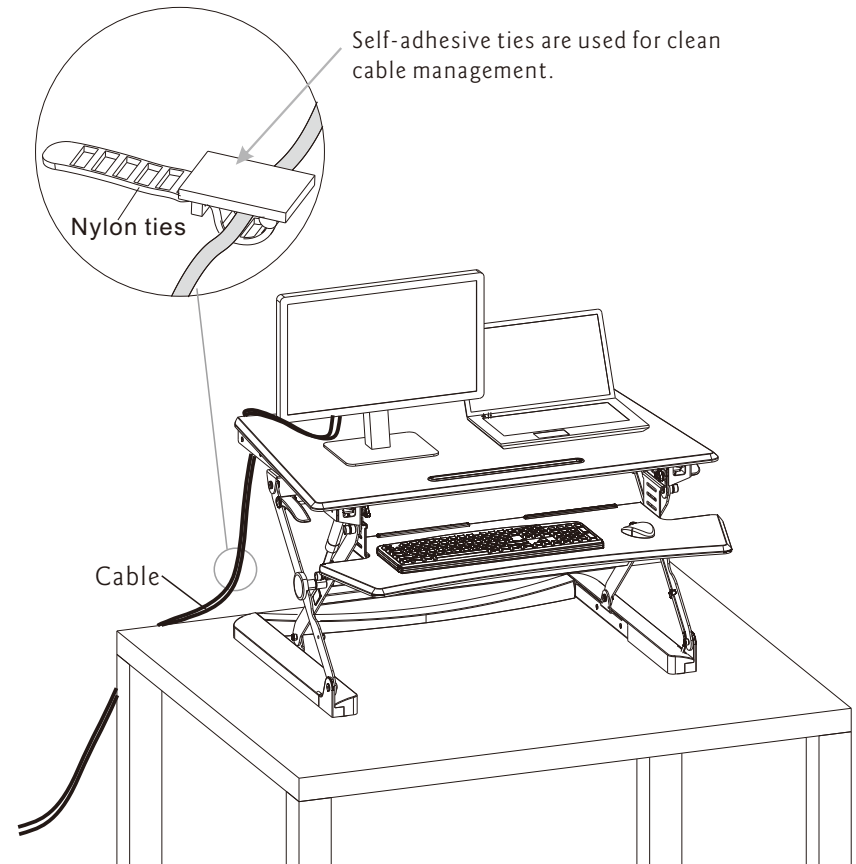

CAUTION

Self adhesive nylon ties are used for cable management. Please install ties while table is at full height to avoid hindering table operation.

ASSEMBLY STEP 4

Please put the devices onto the top of the workstation.
Install equipment and devices onto the workstation.

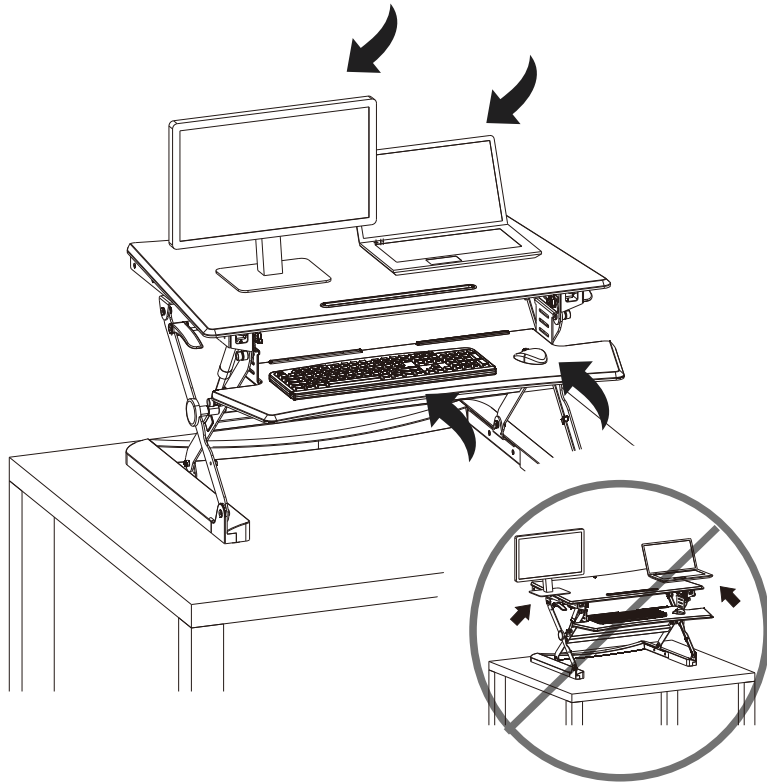

⚠ CAUTION

DO NOT place equipment or devices near the edges of the workstation to avoid damage or injury.

ASSEMBLY STEP 1

Please take the packaging carton apart, take out the product and place it on the table.

Remove all contents from the packaging and place onto sturdy table.
Please ensure all parts have been removed from package and inspect for shipping damage.

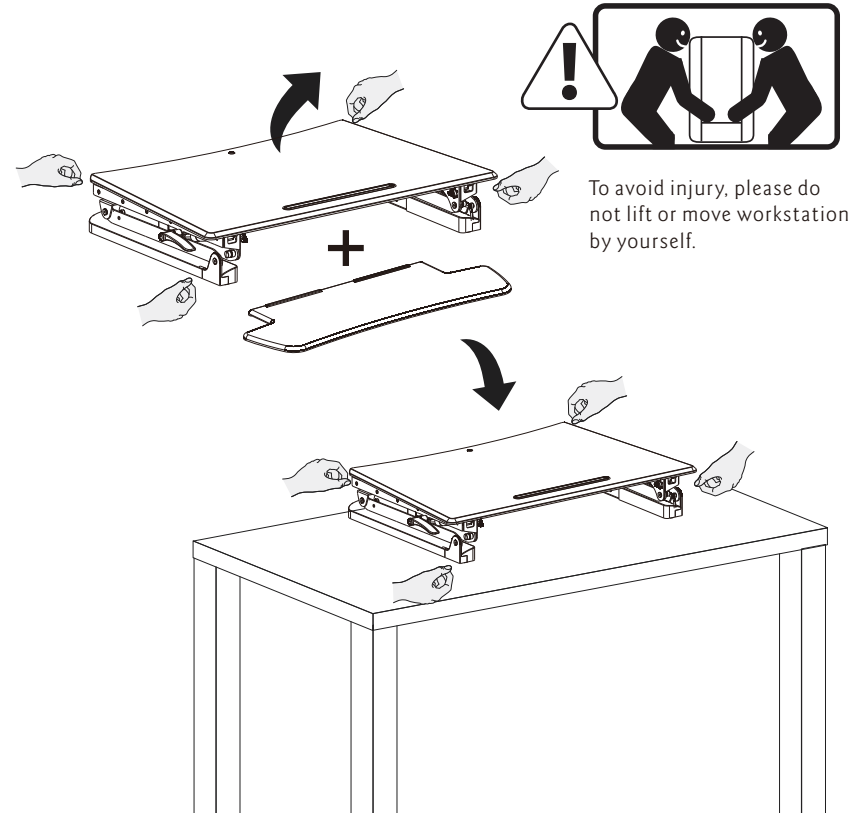

⚠ CAUTION

Ensure the workstation is centered on a flat, level surface before operating

ASSEMBLY STEP 2

- a : Attach decorative cover to the connecting arm.
- b : Using a Philips head screwdriver, attach the junction plate to the keyboard tray with the (8) screws provided.
- c,d: Once keyboard has been attached to the junction plate, hang entire assembly from knob assemblies on each side of workstation and secure by tightening knobs (provided).

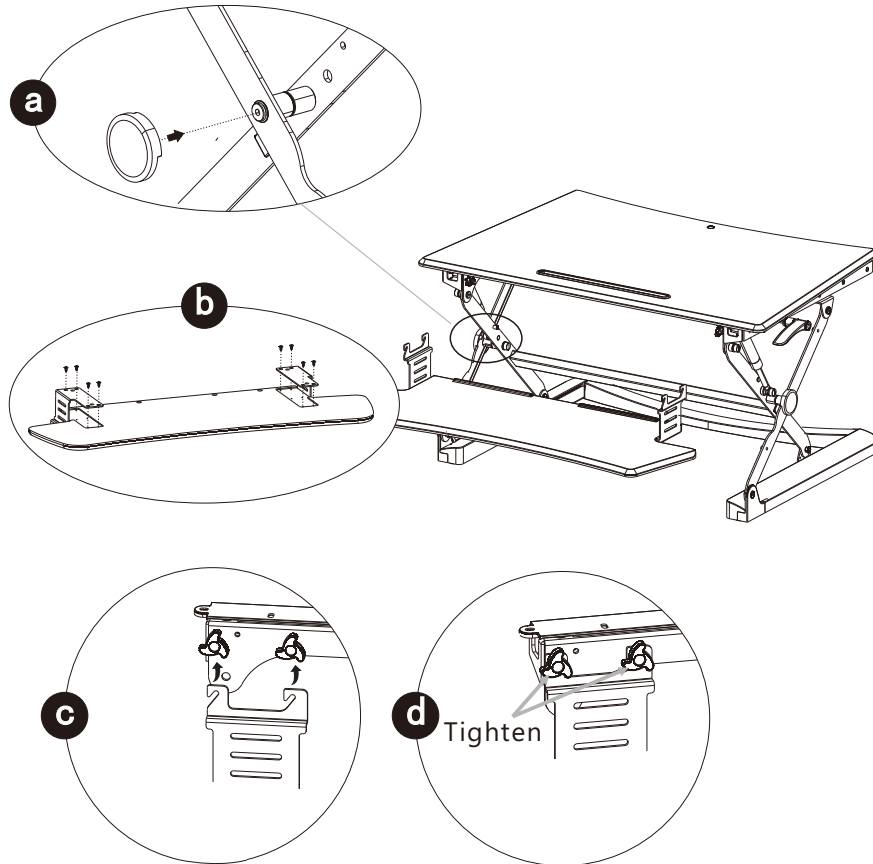

ASSEMBLY STEP 3

To operate the workstation, press the two handle grips (one each side) simultaneously and raise or lower the top to desired height.

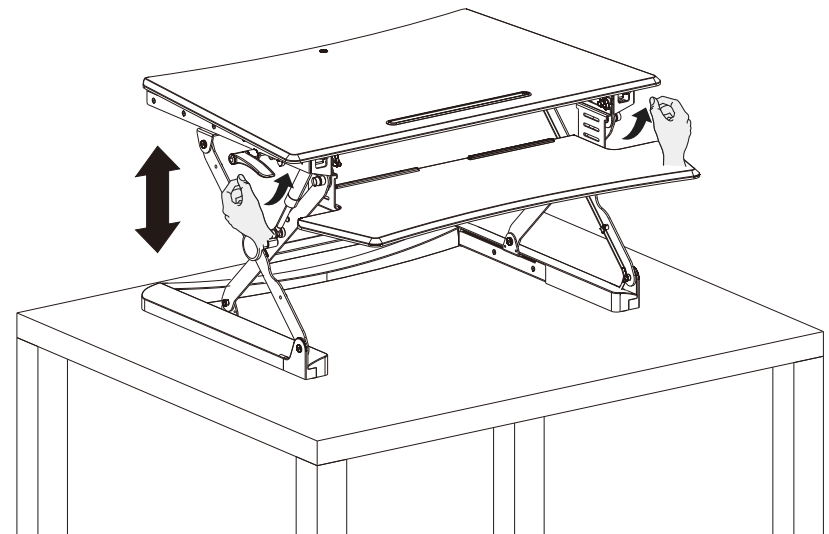

⚠ WARNING

Please keep hands away from the supporting bars during operation as pinching could result.